

Keep the lid on while brewing. The coffee will not drip into the server when the lid is not placed in position.

There are small holes on the bottom for water to drain in case small portions leak into the gaps of the product while using

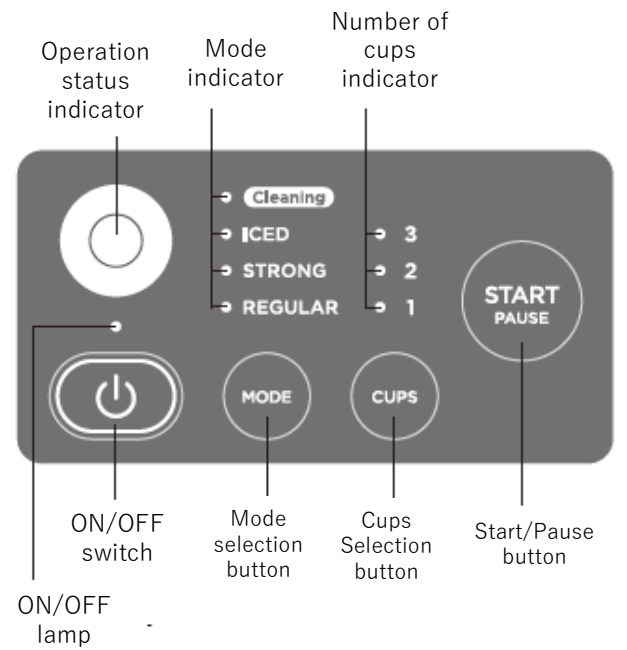

### Accessories

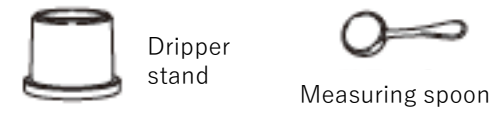

# Clear Brewing Method

A new extraction method using a unique pouring method and fine temperature control.

The temperature, timing and amount of hot water are precisely controlled for each cup and mode setting. In addition, in REGULAR mode, bypass pouring during brewing ensures both a strong flavor and a clear aftertaste.

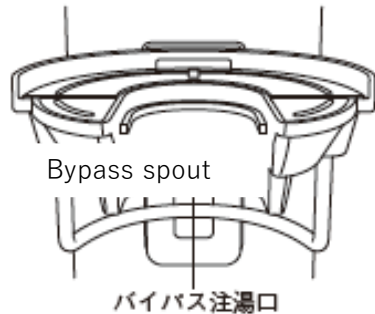

## 3 modes to bring out flavor

### REGULAR

Normal setting for day to day use

### STRONG

Strong but clear aftertaste

	Extract	Amount of coffee grounds
<b>1 cup</b>	Apprx 4 floz	0.28 – 0.42 oz (1 spoon)
<b>2 cups</b>	Apprx 8 floz	0.56 – 0.84 oz (2 spoons)
<b>3 cups</b>	Apprx 12 floz	0.84 – 1.26 oz (3 spoons)

### ICED

A dense extract to dilute with ice or milk

	Extract	Amount of coffee grounds
<b>1 cup</b>	Apprx 3 floz	0.28 – 0.42 oz (1 spoon)
<b>2 cups</b>	Apprx 6 floz	0.56 – 0.84 oz (2 spoons)
<b>3 cups</b>	Apprx 9 floz	0.84 – 1.26 oz (3 spoons)

Adjust the amount of coffee grounds to your liking.  
Use coffee grounds for paper filters.

-----

When using for the first time, wash the dripper and server, and clean the unit by going procedure 1-3 with water only.

1

## Set the coffee grounds

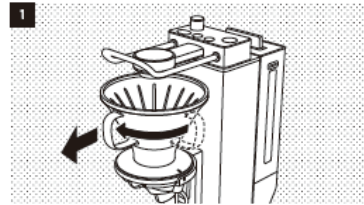

Turn the dripper handle 90 degrees so that it faces outward and slide forward.

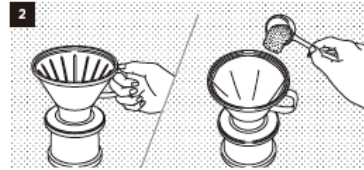

Place the dripper on the dripper stand. Fold the paper filter where it is stitched and set it in the dripper. Put in the coffee grinds. (1 spoon/cup)

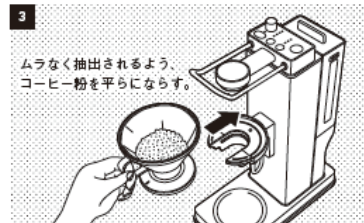

Hold the dripper as shown here and slide it into the unit.

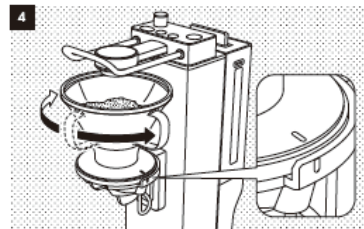

Turn the dripper 90 degrees either to the right or left to set.

2

## Set the water tank

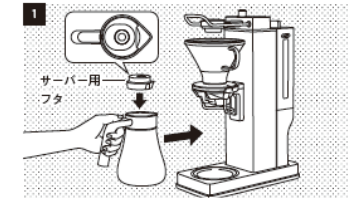

Attach the lid to the server and slide inward. Be sure that the server is empty. Do not put liquid or ice in it, it may overflow.

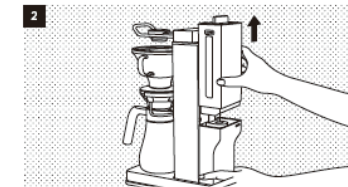

Hold the unit with one hand and slide the water tank upward to detach.

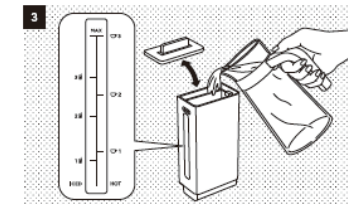

Pour water into the tank. Fill to your desired number of cups. Refer to the water indicator on the tank.

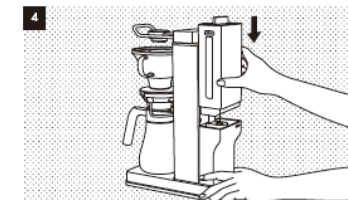

Attach the water tank to the unit.

- 1 Press the On/Off switch to activate



ジケーター  
-ターと杯  
した内容が

- 2 Press the mode button and select a mode.



- 3 Press the cup button and select a mode.



- 4 Press start. The brew will take from 3-6 min, depending on the mode and temperature.



- 5 The operation status indicator will turn off when the brew is done.

- 6 Check that there is no hot water in the dripper left.

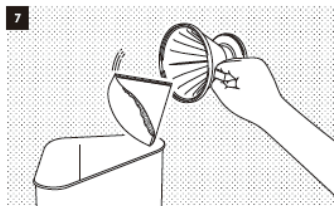

Remove the dripper and throw out the filter and grounds.

Press the start button to pause during brew. The unit will automatically shut off when there is no action for 5 min.

What happens while it brews

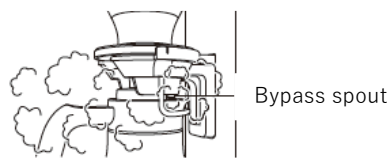

Once the heaters are activated and warmed, for regular and strong mode, steam will be injected into the server to warm it.



Hot water will come out from the nozzle. After 25-40 sec of pre-infusion, it will repeat a cycle of pouring and stopping for several times. When the brewing cycle is over music is played and the operation status lamp will go out.

#### REGULAR / STRONGの場合

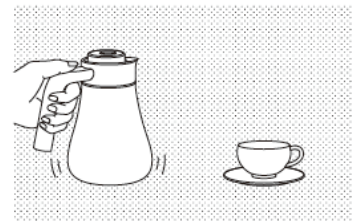

- 1 Remove the server from the unit
- 2 Gently shake the server to even the density of the coffee
- 3 Pour the coffee into a mug or cup. Be sure to empty the server.

#### ICEDの場合

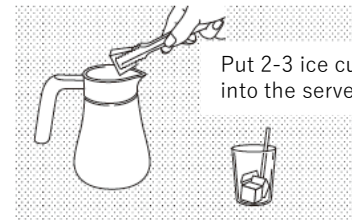

Put 2-3 ice cubes per serving into the server

- 1 Put more ice cubes to your liking in a heat resistant cup
- 2 Remove the server from the unit
- 3 Put 2-3 ice cubes/ serving into the server to adjust the density of the coffee and to slow down the ice in the cup from melting.
- 4 Gently shake the server to even the density of the coffee
- 5 Pour the coffee into the cup. Be sure to empty the server